



**SEMI-AUTO OWNER'S MANUAL**

## **BASIC SAFETY RULES**

**WARNING: PLEASE READ THIS MANUAL BEFORE HANDLING YOUR FIREARM.**

**WARNING: FIREARMS CAN BE DANGEROUS AND CAN POTENTIALLY CAUSE SERIOUS INJURY, DAMAGE TO PROPERTY OR DEATH, IF HANDLED IMPROPERLY. THE FOLLOWING SAFETY RULES ARE AN IMPORTANT REMINDER THAT FIREARM SAFETY IS YOUR RESPONSIBILITY.**

### **1- NEVER POINT A FIREARM AT SOMETHING THAT IS NOT SAFE TO SHOOT.**

Never let the muzzle of a firearm point at any part of your body or at another person. This is especially important when loading or unloading the firearm. When you are shooting at a target, know what is behind it. Some bullets can travel over a mile. If you miss your target or if the bullet penetrates the target, it is your responsibility to ensure that the shot does not cause unintended injury or damage.



### **2-ALWAYS TREAT A FIREARM AS IF IT WERE LOADED.**

Never assume that a firearm is unloaded. The only certain way to ensure that a firearm has the chamber empty is to open the chamber and visually and physically examine the inside to see if a round is present.

Removing or unloading the magazine will not guarantee that a firearm is unloaded or cannot fire. Shotguns and rifles can be checked by removing all rounds and by then opening and inspecting the chamber so that a visual and physical inspection of the chamber for any remaining rounds can be made

### **3- STORE YOUR FIREARM SO THAT CHILDREN CANNOT GAIN ACCESS TO IT.**

It is your responsibility to ensure that children under the age of 18 or other people do not gain access to your firearm. To reduce the risk of accidents involving children, unload your firearm, lock it and store the ammunition in a separate locked location. Please note that devices intended to prevent accidents for example, cable locks, chamber plugs, etc, may not prevent use or misuse of your firearm by a determined person. Firearm storage in a steel gun safe may be more appropriate to reduce the likelihood of misuse of a firearm by an unauthorized child or person.

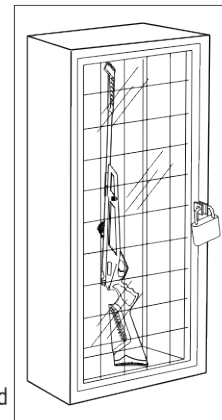

#### 4- NEVER SHOOT AT WATER OR AT A HARD SURFACE.

Shooting at the surface of water or at a rock or other hard surface increases the chance of ricochets or fragmentation of the bullet or shot, which can result in the projectile striking an unintended or peripheral target.



#### 5- KNOW THE SAFETY FEATURES OF THE FIREARM YOU ARE USING, BUT REMEMBER: SAFETY DEVICES ARE NOT A SUBSTITUTE FOR SAFE HANDLING PROCEDURES.

Never rely solely on a safety device to prevent an accident. It is imperative that you know and use the safety features of the particular firearm you are handling, but accidents can best be prevented by following the safe handling procedures described in these safety rules and elsewhere in the product manual. To further familiarize yourself with the proper use of this or other firearms, take a Firearms Safety Course taught by an expert in firearms use and safety procedures.

#### 6-PROPERLY MAINTAIN YOUR FIREARM.

Store and carry your firearm so that dirt or lint does not accumulate in the working parts. Clean and oil your firearm, following the instructions provided in this manual, after each use to prevent corrosion, damage to the barrel or accumulation of impurities which



can prevent use of the gun in an emergency. Before loading your firearm, always check the barrel internal part and the chamber to ensure that they are clean and free from obstructions.

Firing with an obstruction in the barrel or chamber can rupture the barrel and injure you or others nearby. In the event you hear an unusual noise when shooting, stop firing immediately, engage the manual safety and unload the firearm.

Make sure the chamber and barrel are free from any obstruction, like a bullet blocked inside the barrel due to defective or improper ammunition

#### 7. USE PROPER AMMUNITION.

Only use factory loaded, new ammunition manufactured to industry specifications: CIP (Europe and elsewhere), SAAMI. (U.S.A.).be certain that each round you use is in the proper caliber or gauge and type for the particular firearm.

The caliber or gauge of the firearm is clearly marked on the barrels of shotguns and on the slide or barrel of pistols.

The use of reloaded or remanufactured ammunition can increase the likelihood of excessive cartridge pressures, case head ruptures or other defects in the ammunition that can cause damage to your firearm and injury to yourself or others nearby.

#### 8. ALWAYS WEAR PROTECTIVE GLASSES AND EAR PROTECTION WHEN SHOOTING.

The chance that gas, gunpowder or metal fragments will blow back and injure a shooter who is firing a gun is rare, but the injury that can be sustained in such circumstances can be severe,



including the possible loss of eyesight. A shooter must always wear impact resistant shooting glasses when firing any firearm. Earplugs or other high quality hearing protectors help reduce the chance of hearing damage from shooting.

**9- NEVER CLIMB A TREE, FENCE OR OBSTRUCTION WITH A LOADED FIREARM.**

Open and empty the chamber of your firearm and engage the manual safety catch before climbing or descending a tree or before climbing a fence or jumping over a ditch or other obstruction. Never pull or push a loaded firearm toward yourself or another person.



Always unload the firearm, visually and physically check to see that the magazine, loading mechanism and chamber are unloaded and that the bolt is open before handing the firearm to another person.

Never take a firearm from another person unless it is unloaded, visually and physically checked to confirm it is unloaded, and the action is open.

**10- AVOID ALCOHOLIC BEVERAGES OR JUDGMENT/ REFLEX IMPAIRING MEDICATION WHEN SHOOTING.**

Do not drink and shoot. If you take medication that can impair motor reactions or judgment, do not handle a firearm while you are under the influence of the medication.



**11- NEVER TRANSPORT A LOADED FIREARM.**

Unload a firearm before putting it in a vehicle (chamber empty, magazine empty). Hunters and target shooters should load their firearm only at their destination, and only when they are ready to shoot. If you carry a firearm for self-protection, leaving the chamber unloaded can reduce the chance of an unintentional discharge.



**12- LEAD WARNING.**

Discharging firearms in poorly ventilated areas, cleaning firearms, or handling ammunition may result in exposure to lead and other substances known to cause birth defects, reproductive harm and other serious physical injury. Have adequate ventilation at all times. Wash hands thoroughly after exposure.

**WARNING:** It is YOUR responsibility to know and abide by Federal, State and Local laws governing the sale, transportation and use of firearms in your area.

**WARNING:** This firearm has the capability of taking your life or the life of someone else! Always be extremely careful with your firearm. An accident is almost always the result of not following basic firearm safety rules.



### Assembly (from packaged gun)

- a- Stock-receiver-bolt-fore-end
- b- Barrel-brench

### Assembly procedure

1- Take the stock-receive-bolt-fore-end unit unscrew the fore-end cap and remove from the Magazine tube (fig-2)

2- Slide the fore-end off the magazine tube (fig.3)

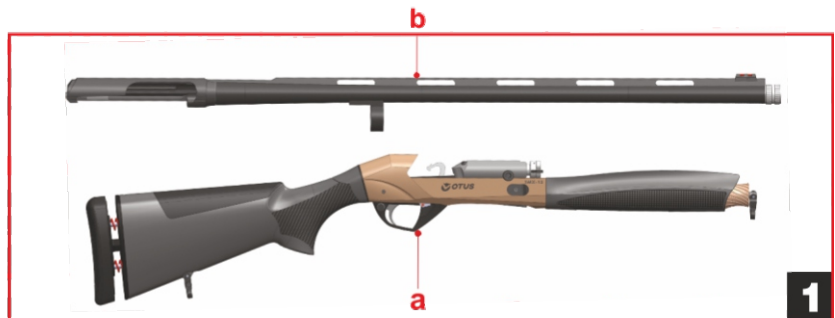

KEY TO ARROW COLOUR	
COLOUR	<i>description</i>
<b>red</b>	stripping sequence
<b>green</b>	assembly sequence
<b>blue</b>	location
<b>yellow</b>	action



3- Take the stock-receiver-bolt unit with one hand with the other hand, acting on the front of the bolt locking head, bring the bolt to open position (fig.4).

**WARNING:** should the bolt fail to engage, move the cartridge drop lever as arrowed and repeat the operation (fig-5).

During the following operations the bolt group should be position completely assembled and placed in the receiver, the in open position.

4- Install the fore-end on the barrel-breech unit. The fore-end must first be slid over the barrel guide ring (fig-6) and then snapped onto the barrel (fig-7).

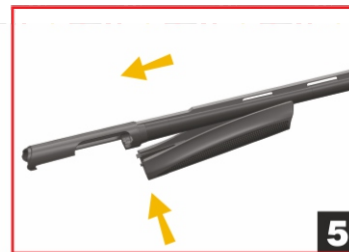

5- Take the stock-receiver -bolt unit with one hand and with the the other hand take hold of the Previously formed barrel-breech-fore-end unit .Slide the fore-end down the magazine tube, making sure that the cover goes over the magazine tube (fig-8) and that it is properly centered on the receiver So that the bolt unit can be properly seated (fig-9) and the barrel-breech -fore-end unit is pushed all the way in (fig-10) that is until you cannot push it furhter and the assembly clicks against the metal and the cover adheres perfectly to the receiver (fig-11).



6-Screw the fore-end cap all the way to the end of the tubular magazine (fig-12).Fasten it tightly so that the barrel-cover unit is firmly seated against the receiver (fig-11).



7- The cocking lever comes already assembled on the packed shotgun (fig-13).



8- Close the bolt by pressing the special carrier control button (fig-14).

### GUN SAFETY CATCH

Press the safety button on the trigger guard until its red ring, indicating firing position, is no longer visible (figs-15-16)

### LOADING

Before starting any operation on your shotgun, make sure that the chamber and the magazine tube are unloaded! (Carefully read the instructions on gun loading and unloading.)

**NOTE:** Make sure that your firearm is fitted with a magazine tube containing a number of cartridges permitted by legislation in the country where you intend to use it.

### LOADING PROCEDURE

**NOTE:** Make sure that the shotgun safety catch (see "Gun safety catch") is engaged and the hammer cocked (so that the carrier latch can retain the cartridges as they are inserted in the magazine tube.

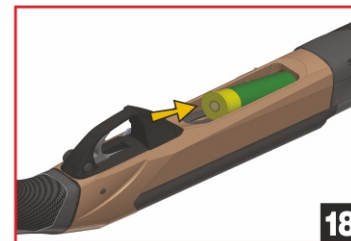
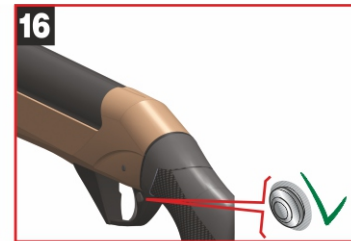
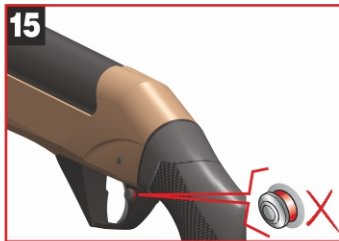

**WARNING:** For safety reasons, check by opening the bolt that the shotgun is unloaded. Then close the bolt again.

1- The red dot on the cartridge drop lever (indicating that the hammer is cocked) must be clearly visible. To bring lever to this position press the carrier button and open the bolt by hand, then bring it to close position again (fig-17).

2- With the bolt closed and the hammer cocked, reverse the gun pointing the barrel downwards.

3- Insert a cartridge in to the magazine (fig-18): push it until it is retained by the carrier latch which engages automatically (fig-19) Repeat the operation until the magazine is fully loaded.

**NOTE:** The shotgun must be loaded with the hammer cocked so that the carrier latch retain the cartridges as they are inserted in the magazine.

Now the gun cannot be fired unless a cartridge is placed in the barrel, following the relative procedure:

- 1- Open the bolt and at the same time insert a cartridge into the barrel through the case ejection port (fig-20)
- 2- Release the cocking lever: the bolt will push the cartridge on the carrier into chamber and stop in the closed position.

### **CARTRIDGE REPLACEMENT:**

To replace a cartridge in the chamber, two procedures can be followed:

- A- By manual replacement of a new cartridge;
- B- By using the cartridge drop lever.

**A-) Manual replacement** (when the cartridge is not coming from the magazine).

- 1- Rest the stock on your hip and pull the cocking lever to open the bolt: the cartridge in the Chamber is extracted and ejected from the shotgun (fig-21).
- 2- Insert a new cartridge even partially in the barrel through the special ejection window (fig-20) and release the cocking lever to close the bolt again.

**B-) Using the cartridge drop lever** (when the cartridge is coming from the magazine)

- 1- Rest the stock on your hip and pull the cocking lever to open the bolt: the cartridge in the chamber is extracted and ejected from the gun (fig-21)
- 2- Press the cartridge drop lever (fig-4) and release the cocking lever to close the bolt again. In this way, the cartridge will pass quickly from magazine to the chamber.

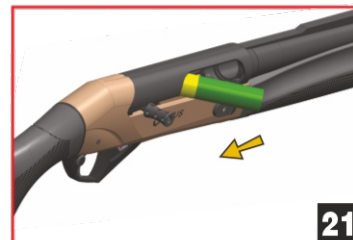
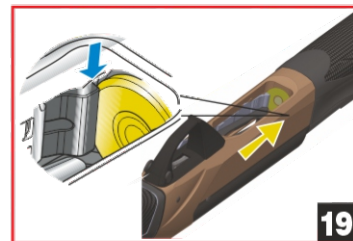

## UNLOADING

(This operation must be carried out with the gun safety catch engaged and the barrel pointed in safe direction) to unload the shotgun, proceed as follows;

- 1- Engage the safety catch; rest the stock on your hip and pull the cocking lever to open the bolt (fig-21) the cartridge in the chamber is extracted and ejected from the gun.
- 2- Gently release the cocking lever to close the breech block (fig-14)
- 3- Reverse the gun and thrust the carrier down ,press sideways the carrier latch frontal part with your index (fig-22)
- 4-The cartridges will be released one by one into your hand (fig-23);the carrier latch must be pressed for each released cartridge.

**WARNING:** Gun can be unloaded by repeating the operation, as described under point B of the chapter “Cartridge replacement”

## TROUBLESHOOTING:

Before starting any operation on your shotgun, make sure that the chamber and the magazine tube are unloaded!

The gun fails to fire.

- 1- Check the safety catch: If it is engaged ,push the button to the fire position.
- 2- Check that there is a cartridge in the barrel. If necessary ,insert a cartridge following the Loading instructions (page 8.)
- 3- Check the firing mechanism. If necessary, clean and lubricate it.

## Fore-end cap

Especially after the first rounds ,check that the fore-end cap is firmly tightened, to keep the barrel firmly against receiver.

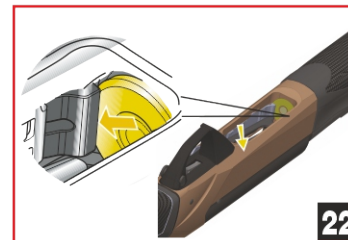

## SHOTGUN STRIPPING

(for cleaning and maintenance)

Before starting any operation on your shotgun, make sure that the chamber, carrier and the Magazine are unloaded! (Carefully read the instructions on gun loading and unloading.

### STRIPPING PROCEDURE

- 1- Open the bolt by pulling back the cocking lever (fig-17) until the bolt is locked open. Should the bolt fail to engage, move the cartridge drop lever as arrowed and repeat the operation (fig-4).
- 2- Pull the cocking lever off with a firm tug (fig-24).
- 3- Unscrew the fore-end cap and remove from magazine tube (fig-25).
- 4- While resting the stock against your hip, grab the stock receiver unit with a hand and the barrel-cover-fore-end unit with the other hand (fig-26) Pull the latter forward and completely off the magazine tube (fig-27).
- 5- Rotate the barrel-cover-fore-end-unit in the direction shown by the arrow (fig-28) and separate it from the barrel by pulling it out of the barrel guide ring (fig-29).

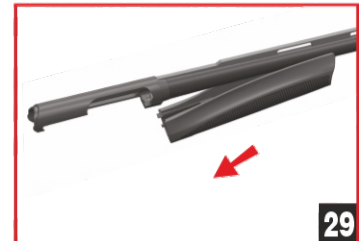
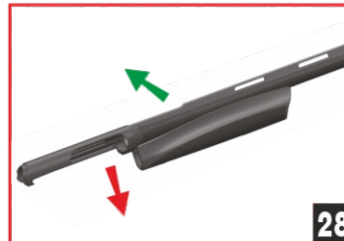



6- While holding the bolt assembly with one hand (fig-3) so as to counter-balance the thrust of the recoil spring, push the carrier button (fig-14) and ease the bolt forward until the recoil spring no longer pushes it forward (fig-30)

7- Pull the bolt assembly out of the receiver, sliding it along its guides (fig-31)

8- Remove the firing pin retaining pin from the bolt assembly, while holding the firing pin and firing pin spring in place (fig-32)

9- Remove the firing pin and firing pin spring from the bolt (fig-33)

10- Remove the locking head rotating pin from its seat (fig-34)

11- Remove the bolt locking head from bolt (fig-35)

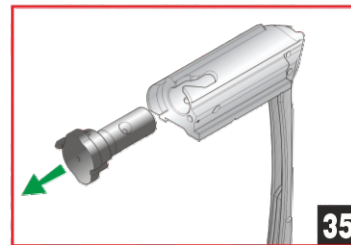
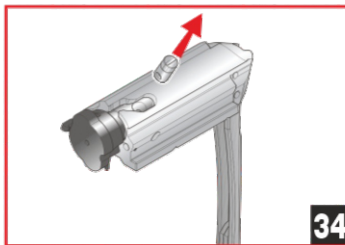
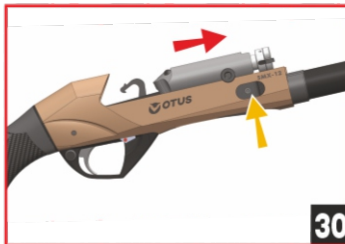

12- Remove the recoil spring from its seat in the bolt (fig-36).

13- Extract the trigger guard pin from the stock receiver unit, thrusting it from right or left with the point of the same firing pin or punch (fig-37).

14- Press the carrier button and extract the trigger guard assembly towards the front (fig-38).

### SHOTGUN ASSEMBLY

For correct assembly after cleaning and maintenance operations, proceed as follows:

1- Grip the stock-receiver assembly and press the carrier button, insert the complete trigger guard assembly with cocked hammer in the receiver, positioning its frontal part up to the stop (fig-39) and insert the trigger guard assembly completely in the receiver (fig-40).

2- Push the trigger guard pin into the receiver from the right or left, until it is completely inside (fig-41).

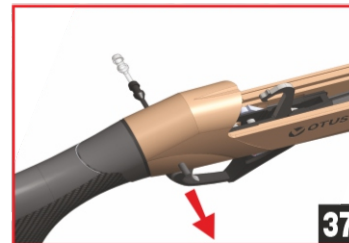
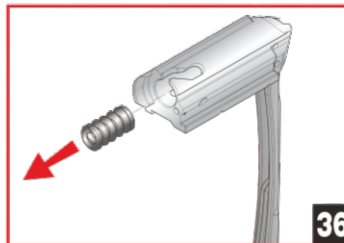

3- Place the bolt recoil spring in its seat on the bolt (fig-42).

**NOTE:** Always make sure that the bolt recoil spring is positioned between the locking head and the bolt itself, in order to avoid a shot being fired during the closing phase.

4- Slide the locking head into the bolt, making sure that the hole on it's stem coincides with the slot on the bolt (fig-43).

**WARNING:** The slanted surfaces on the locking head's stem should not be visible once the bolt locking head is mounted.

5- Insert the lockinghead pin in its hole on the locking head's stem, through the slot on the bolt (fig-44).

**NOTE:** The reference line on top of the pin must be visible and aligned with the bolt assembly longitudinal axis (fig-44).

6- Insert the firing pin and the firing pin spring inside the bolt hole (fig-45).

**NOTE:** Always make sure that the firing pin spring has been mounted.

7- Insert the firing pin retaining pin in its seat, so as block the firing pin (fig-46).

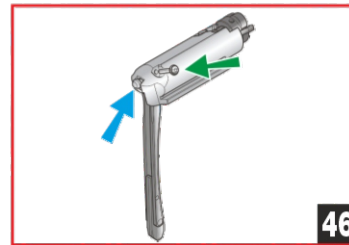
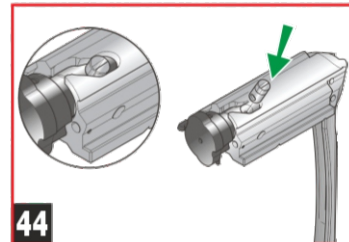
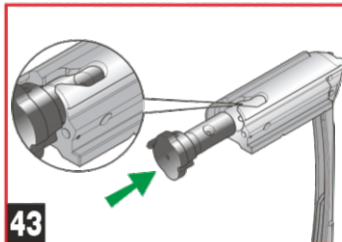
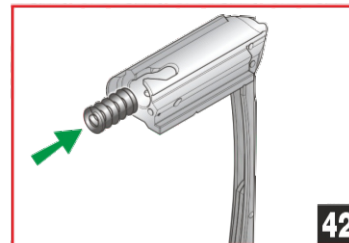

8- Hold the stock receiver assembly almost vertically and insert the bolt assembly in its guide on the receiver (fig-47).



**WARNING:** Make sure that the bolt link slides over the trigger guard assembly, positioning on the recoil spring guide pin inside the receiver once the mounting has been completed (fig-48).

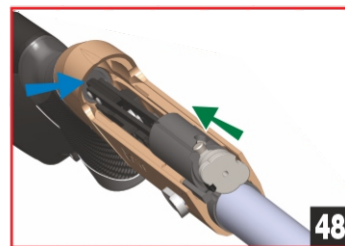

### **AMMUNITION**

The Otus semi-automatic use the kinetic energy generated by the recoil to work the action.

Always use ammunition that is powerful enough to fully cycle the action. (1300 FPS MINIMUM)

**WARNING:** when your shotgun is new and before beginning to use it normally, a break-in period may be required before your new gun works perfectly with light target loads. If you experience any initial functioning problems, we recommended firing three or four boxes of standard hunting cartridges. (75-100 ROUNDS OF 1500 FPS AMMUNITION)

### **Choice of ammunition**

Correct functioning of the shotgun is only guaranteed with cartridges of a maximum length of 58 mm (2 3/4" - 70 mm chamber), 66 mm (3" - 76 mm chamber) or 78 mm (3 1/2" - 89 mm chamber). The shotgun accepts cartridges with rolled turnover or crimped closures, and with lead or steel shot.

This is not mandatory but will ensure top-notch performance.

**CAUTION:** Never use cartridges with a case longer than the chamber. Non-compliance to this rule could have serious consequences for both the shotgun and the shooter.

No adjustment to the shotgun is necessary to fire any of the ammunition listed above.

Always use ammunition that is powerful enough to fully cycle the action.

## ACCESSORIES AND ADJUSTMENTS

### Drop and cast adjustment

Before beginning any operation on your shotgun always make sure that chamber and magazine have been completely emptied !

(Carefully read loading and unloading instructions).

DROP CHANGE SCHEDULE			
Cast shim (plastic)	Stock locking plate (steel)	Drop shim (plastic)	Drop value at heel (mm)
Reference letter	Reference letter	Reference letter	
DX	Z DX	Z	$50 \pm 1$ DX
SX	Z SX		$50 \pm 1$ SX
DX	A DX	A	$55 \pm 1$ DX
SX	A SX		$55 \pm 1$ SX
DX	B DX	B	$60 \pm 1$ DX
SX	B SX		$60 \pm 1$ SX
DX	C DX	C	$65 \pm 1$ DX
SX	C SX		$65 \pm 1$ SX

The shotgun is supplied with a drop change kit( fig. 49) which enables you to adjust the original drop of the shotgun is supplied with. The kit includes a stock locking plate (in steel), and three drop change shims (in plastic). The kit enables you to obtain four different drop patterns (as specified in the following table) and two different deflections (right hand or left hand). Each unit is marked with the corresponding drop and cast letter.

Determine if your stock drop fits you perfectly, or whether it is either too high or too low for you. If it is too low, you need to select the previous adjustment set in alphabetical order (e.g. if the shim supplied on the shotgun is marked with a C, you must select the B, together with the corresponding stock locking plate).

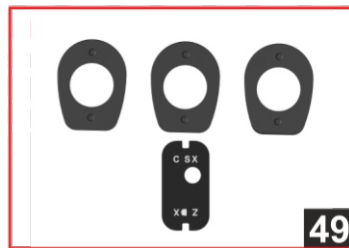

### Matching instructions:

The drop change shims and stock locking plates identified by letters.

To ensure a correct drop always use plates and shims with the same letter, e.g.:C-CDX—for A 65-RH drop or C-CSX—for a 65-LH drop DX= Right hand SX=Left hand

## INTERNAL CHOKE

Before starting any operation on your shotgun, make sure that the chamber and the magazine are unloaded!

(Carefully read the instructions on gun loading and unloading).

The barrels with internal chokes are equipped with various types of chokes.

**WARNING:** Before using the shotgun, make sure that the barrel has a choke correctly installed.

**NOTE:** If correctly installed, internal chokes must not protrude from the barrels muzzle. Only use Otus chokes of a length suitable for the choke seat of the barrel. To change or clean the internal choke, proceed as follows:

- 1- Unscrew the internal choke using the special choke wrench supplied with the shotgun and extract it completely from the barrel seat (fig. 51).
- 2- If the choke threads become badly fouled, clean them with the serrated side of the choke wrench.
- 3- Reassemble the kind of choke required on the barrel seat, taking care to insert the nonthreaded part in side the barrel; then screw the choke on the barrel thread (fig . 52).
- 4- Complete install ation of the choke using the toothed wrench provided (fig. 51).

Before the shotgun is put away, cleaning the internal choke and relative barrel thread is recommended. Otus chokes are marked for an easy identifi cation (fig. 54). Notches on the frontal part of each choke allow a quick recognition, even when the choke is mounted on the shotgun.



50

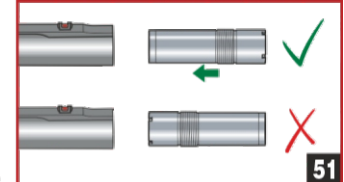

51

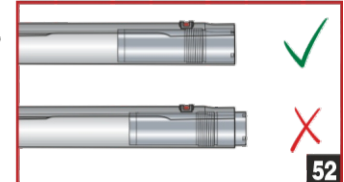

52

NOTCHES	CHOKE	SYMBOL	STEEL SHOT
I	Full	X	NO
II	Improved Modified	XX	NO
III	Modified	XXX	OK
IIII	Improved Cylinder	XXXX	OK
IIIII	Cylinder	XXXXX	OK

**NOTE:** before using steel shot cartridges, make sure that the choke fitted in the barrel is marked "STEEL SHOT - OK" (see table above).

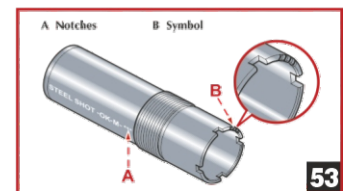

53

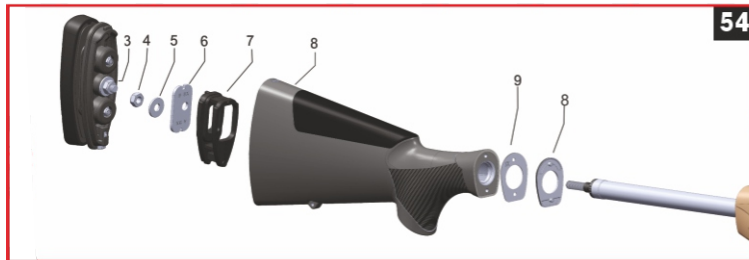

Replacement procedure is very simple (fig. 54).

- 1) Grasp the bottom of the buttstock "1" and pull upwards (figs. 55-56)
- 2) Unscrew the stock retaining nut "2" (using a 13 mm hexagon wrench).
- 3) Take the nut "2", the lock washer "3", the stock locking plate "4", synthetic part "5", the stock "6", the cast shim "7" and the drop shim "8" out of the recoil spring tube.

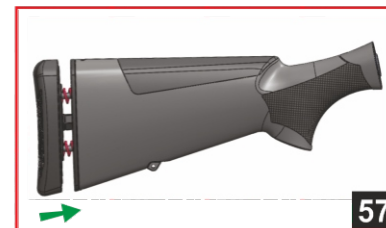
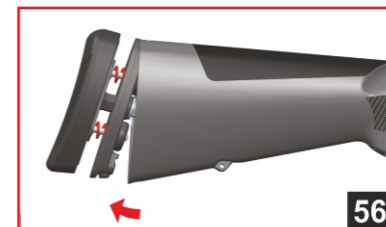
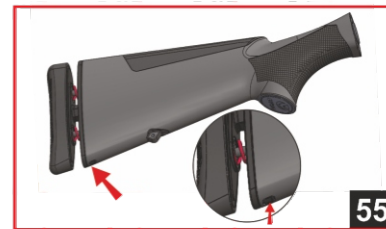



### Removing and changing the comb (synthetic stock)

Proceed as follows to remove and change the comb.

1) **Disassemble the butt pad from the stock** (see figure 54).

2) Acting from the back side of the stock, lift the tongue according to the direction of the stamped arrow, and then slide it back, releasing the comb (fig. 58). Slightly rotate the comb and slip it off from the back by removing it from the stock (fig. 59)

3) To assemble the new comb, place the front disconnector and side hooks on the stock then rotate it into its seat (fig. 60).

4) Pressing and holding the comb in position, fasten it by returning the tongue in its initial position, pushing it forward until it clicks into place (fig. 61).

**WARNING:** the comb properly assembled mates perfectly with the external profile of the stock.

5) Assemble the **buttpad** on the stock (see fig 54).

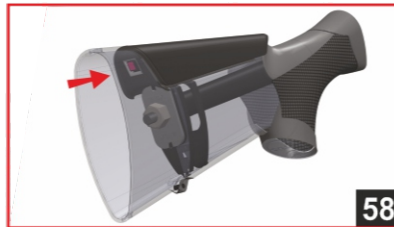
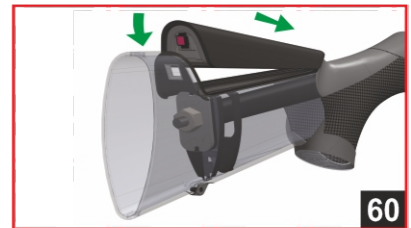

**Drawing A**

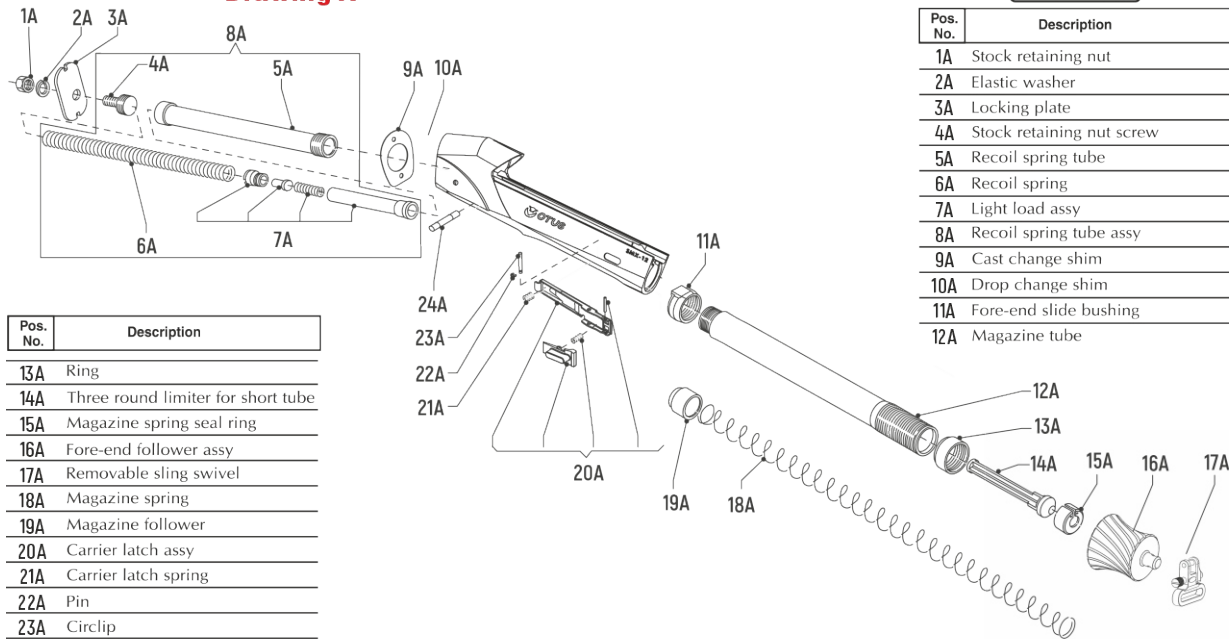

**Part List A**

Pos. No.	Description
13A	Ring
14A	Three round limiter for short tube
15A	Magazine spring seal ring
16A	Fore-end follower assy
17A	Removable sling swivel
18A	Magazine spring
19A	Magazine follower
20A	Carrier latch assy
21A	Carrier latch spring
22A	Pin
23A	Circlip
24A	Trigger guard pin

Pos. No.	Description
1A	Stock retaining nut
2A	Elastic washer
3A	Locking plate
4A	Stock retaining nut screw
5A	Recoil spring tube
6A	Recoil spring
7A	Light load assy
8A	Recoil spring tube assy
9A	Cast change shim
10A	Drop change shim
11A	Fore-end slide bushing
12A	Magazine tube

## Drawing B

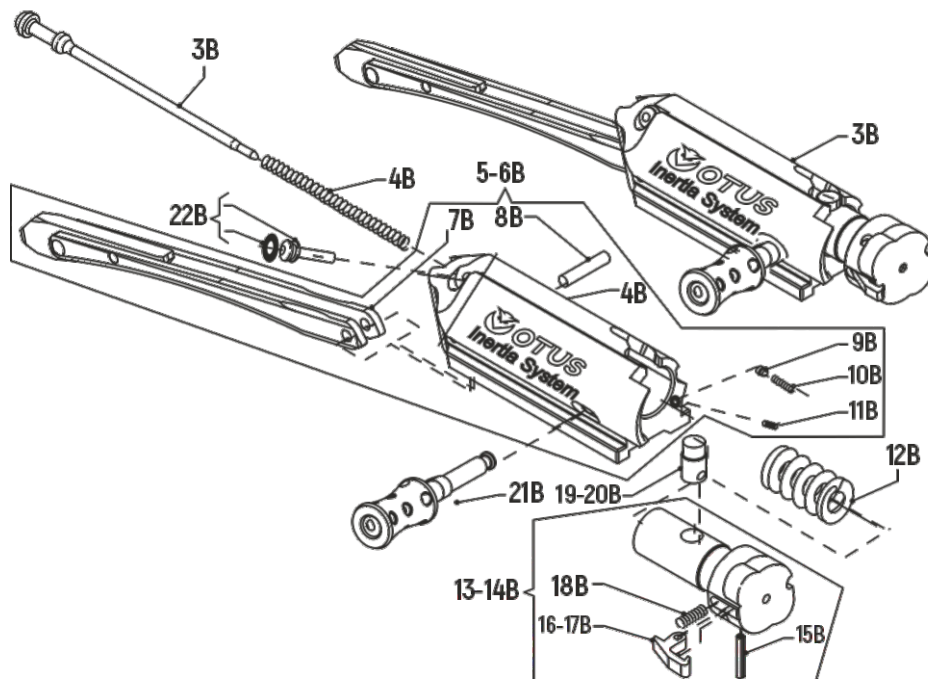

### Part List B

Pos. No.	Description
1B	Bolt assy
2B	Bolt
3B	Firing pin
4B	Spring
5B	Bolt, partial
6B	Bolt, partial
7B	Link
8B	Link pin
9B	Pin
10B	Spring
11B	Pin
12B	Spring
13B	Locking head assy
14B	Locking head assy
15B	Pin
16B	Extractor
17B	Extractor
18B	Spring
19B	Locking pin
20B	Locking pin
21B	Bolt
22B	Retaining pin

**Drawing C**

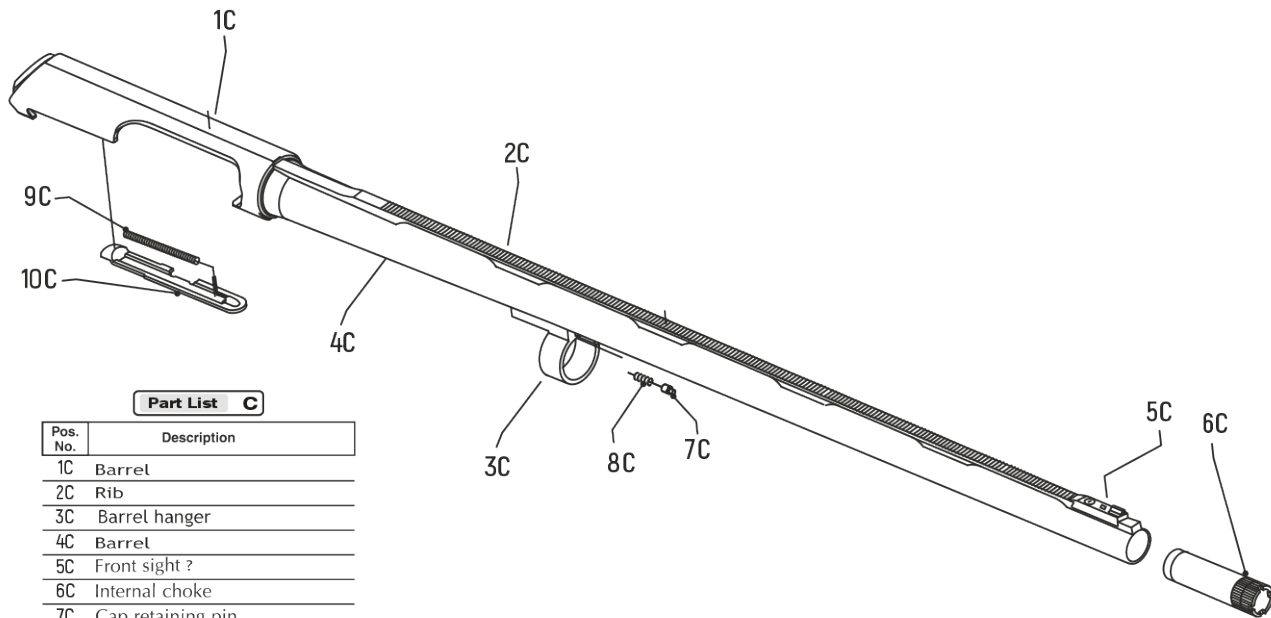

**Part List C**

Pos. No.	Description
1C	Barrel
2C	Rib
3C	Barrel hanger
4C	Barrel
5C	Front sight ?
6C	Internal choke
7C	Cap retaining pin
8C	Cap retaining pin spring
9C	Ejector plate spring
10C	Ejector plate

### Drawing D

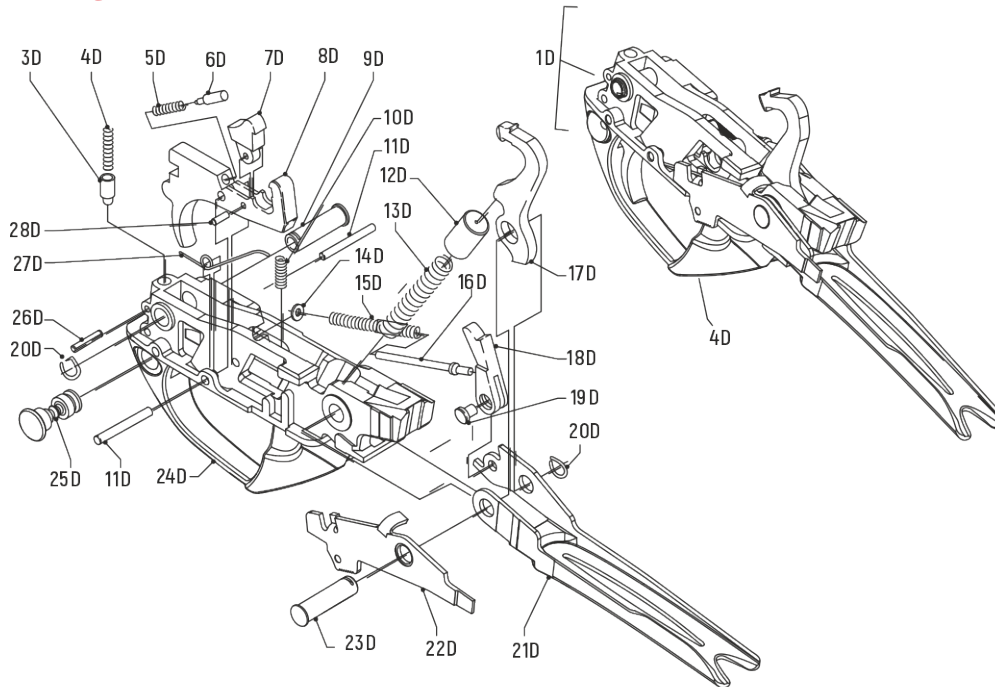

#### Part List D

Pos. No.	Description
1D	Trigger guard assy
2D	Trigger guard
3D	Hand safety plunger
4D	Safety plunger spring
5D	Disconnecter spring
6D	Pin
7D	Disconnecter hammer
8D	Trigger
9D	Trigger pin bush
10D	Trigger spring
11D	Trigger pin
12D	Hammer spring cap
13D	Hammer spring
14D	Washer
15D	Carrier spring
16D	Bolt latch pin
17D	Hammer
18D	Bolt stop tooth
19D	Bolt stop tooth pin
20D	Trigger guard pin spring
21D	Carrier
22D	Cartridge drop lever
23D	Carrier pin
24D	Trigger guard
25D	Hand safety button
26D	Safety spring retaining pin
27D	Cartridge drop lever spring
28D	Disconnecter pin

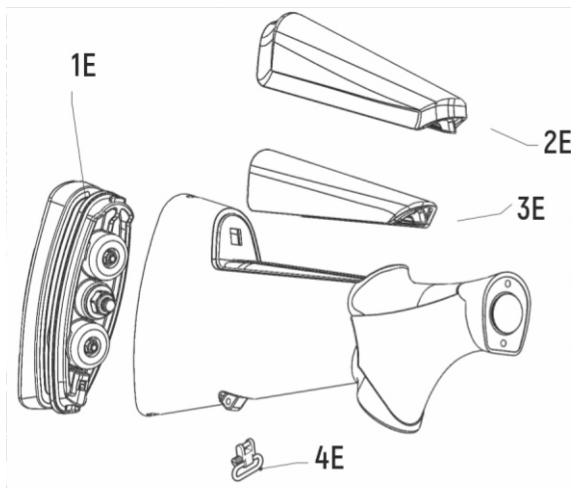

Part List **E**

Pos. No.	Description
1E	Polyurethane recoil pad, small
2E	Polyurethane comb, medium
3E	Polyurethane comb, low
4E	Removable sling swivel
5E	Spring washer
6E	Elastic ring
7E	Washer

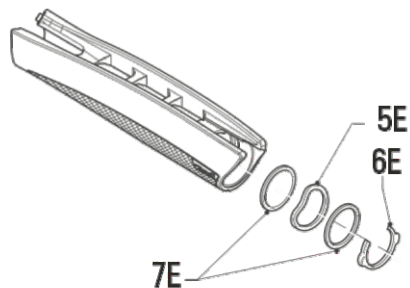

---

**NOTES**



55 Bradrock Dr.  
Suite A  
Des Plaines, IL 60018

(847) 768-1011 - Phone  
(847) 768-1001 - Fax  
[otusarms.com](http://otusarms.com)